

## TILE INSTALLED ON WOOD STAIRS, INTERIOR ONLY (318S-2009/2010)

**SUITABLE SUBSTRATES:** Nail galvanized metal lath to wood substrate over cleavage membrane (vapour barrier). Install mortar bed and tile according to detail 308W-2009/2010 but increase thickness of mortar bed on horizontal surface to a minimum of 32 mm (1 1/4").

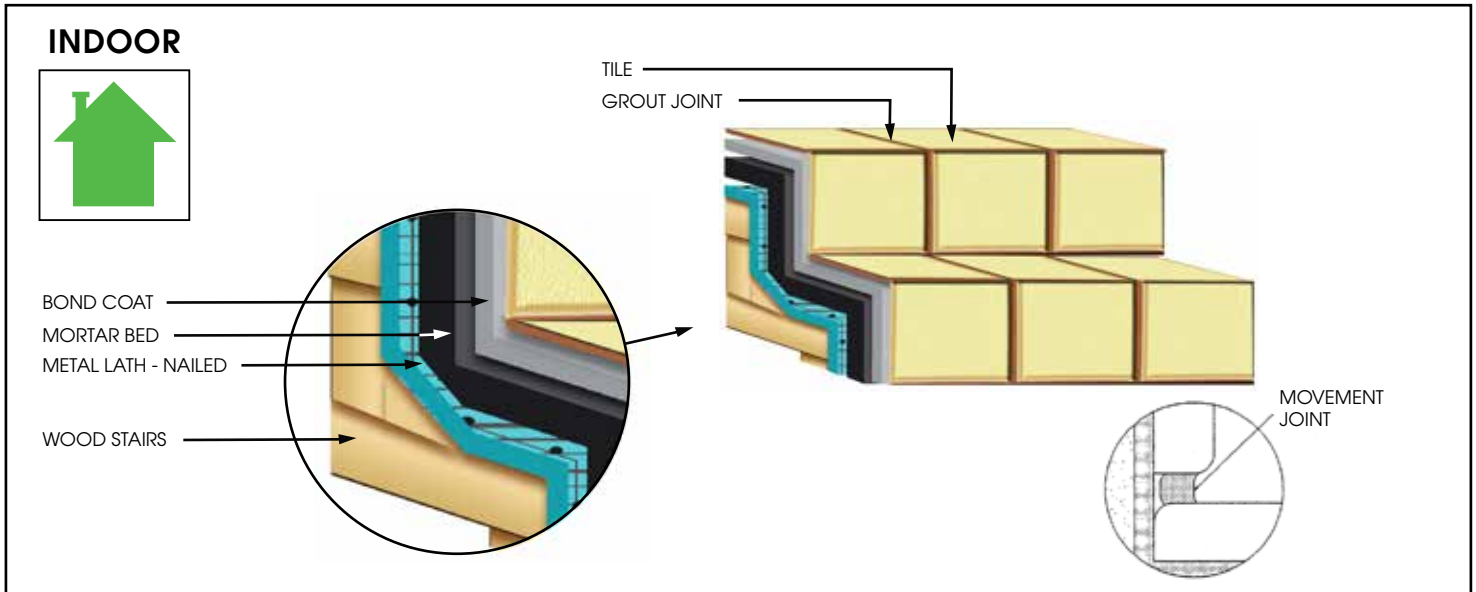

### MATERIALS

**TILE:** Ceramic, porcelain, mosaic, quarry, agglomerate, precast terrazzo, natural stone.

**METAL LATH:** 1.4 kg/m (ASTM C847-96)

**MORTAR BED:** (20 mm - 3/4" minimum) See Tile Guide Specification Section Mixes 2.5.3.

**BOND COAT:** Prolastic 6 500/8 500, Litefix, Megaflex, Multirapid, Multiflex, Ceraflex, Optiflex, Flex GT-30.

**GROUT:** POLY 500 sanded, POLY 600 unsanded or POLY 800 Precision Water-Based Epoxy Grout.

**MOVEMENT JOINT:** POLY 400U or POLY 400S.

### LIMITATIONS

Organic adhesives are not acceptable for these applications.

### OTHER CONSIDERATIONS

- For easy maintenance, use cove base tile or cove movement profile at junction of riser and tread. Wood stairs not recommended for exterior applications. On exterior stairs, a slight slope on treads is preferred to provide drainage. Provide tactile surface prior to stairs where required for visually handicapped. Where required, use a 51 mm (2") strip of contrasting colour at edge of first and last step.
- Precast terrazzo and natural stone tile may be used providing that slip resistant properties are acceptable.
- Mortar bed may be installed over fresh scratch coat.
- Prefabricated stair nosings or carborundum inserts should be used for increased safety precautions.
- To minimize the potential for cracking use a sealant or prefabricated movement joint at the junction between the riser and tread.
- Treads and risers must have uniform rise and run in any one flight.
- Refer to Notes For The Professional and 301MJ-2009/2010.