

TILE INSTALLED ON CEMENTITIOUS BACKER UNIT (CBU) - THIN-SET METHOD/WALLS (305W-2009/2010)

SUITABLE SUBSTRATES: Wood studs for interior use only or metal studs maximum 406 mm (16") o.c.

OUTDOOR

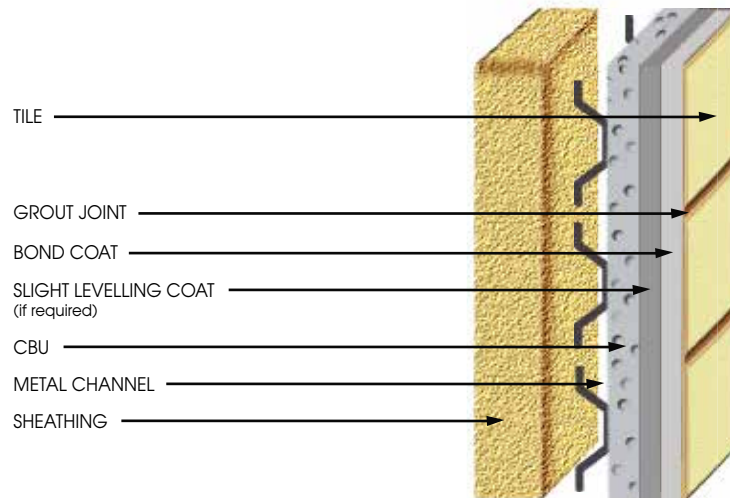

MATERIALS

TILE: Ceramic, porcelain, mosaic, quarry, agglomerate, precast terrazzo, natural stone (Prost resistant materials only).

VAPOUR BARRIER: 6 mils (1/4") polyethylene film. Required in exterior and wet areas.

CEMENTITIOUS BACKER UNIT (CBU): Minimum 13 mm (1/2") thick meeting ANSI A118.9-1999 (2008) or nominal 11 mm (7/16") thick fibre-cement backer board meeting ASTM C-1288-1999.

WATERPROOF MEMBRANE AND CRACK SUPPRESSION SYSTEM, IF REQUIRED: Imper.

SLIGHT LEVELLING COAT, IF REQUIRED: Prolastic 6 500/8 500, Litefix, Megaflex, Multirapid.

BOND COAT: Prolastic 6 500/8 500, Litefix, Megaflex, Multirapid.

GROUT: POLY 500 sanded mixed with 9022 latex additive.

APPLICATION

Cementitious backer unit (CBU) must be stable, plumb, square and screwed to studs with corrosion resistant fasteners. Surface variation in the backing not to exceed 6 mm in 3049 mm (10') or 2 mm (1/16") in 305 mm (12"). Apply levelling coat if required. All joints must be taped with 51 mm (2") fibre-mesh tape, fill with a dry-set or latex mortar and sand. Apply thin-set bond coat to cement board surface using proper notched trowel to ensure adequate bond. Slide tile firmly into position while bond coat is wet and tacky. Use sufficient bond coat to ensure minimum 95% contact. Force grout into full depth of joint, remove excess grout and clean.

LIMITATIONS

- PROFIX's recommendations must be followed. Exterior tile installations should not be attempted when temperature is less than 12°C (54°F). Do not use paper-back, mesh-back or dot mounted tile for exterior use or in locations of extreme moisture unless the manufacturer guarantees that the material is suitable for this type of installation.

OTHER CONSIDERATIONS

- Spacing and minimum gauge of steel studs as per instructions of manufacturer of cementitious backer unit (CBU). On exterior installation, drill approximately 6 mm (1/4") weep holes in grout joints at the bottom of the wall to prevent spalling of cementitious backer unit (CBU) due to freeze thaw action or follow manufacturers recommendations.
- Imper Waterproofing membrane if required must be specified. (ANSI A118.10-2008) Follow PROFIX's recommendations.
- Special care must be taken when installing tile thicker than 13 mm (1/2") to prevent slippage or debonding.
- Refer to Notes For The Professional and 301MJ-2009/2010.
- All openings and cuts must be treated to ensure waterproof integrity.